

# 大全村大農溪綠覆保育工程

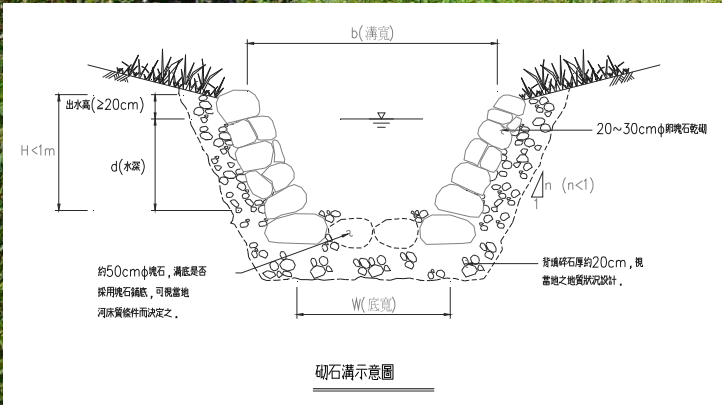

農塘模擬Simulation of Farm Ponds

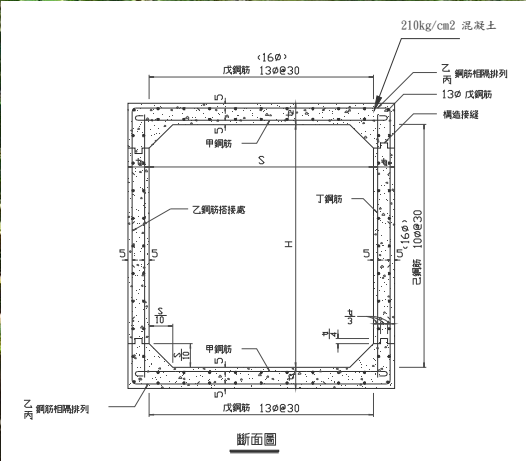
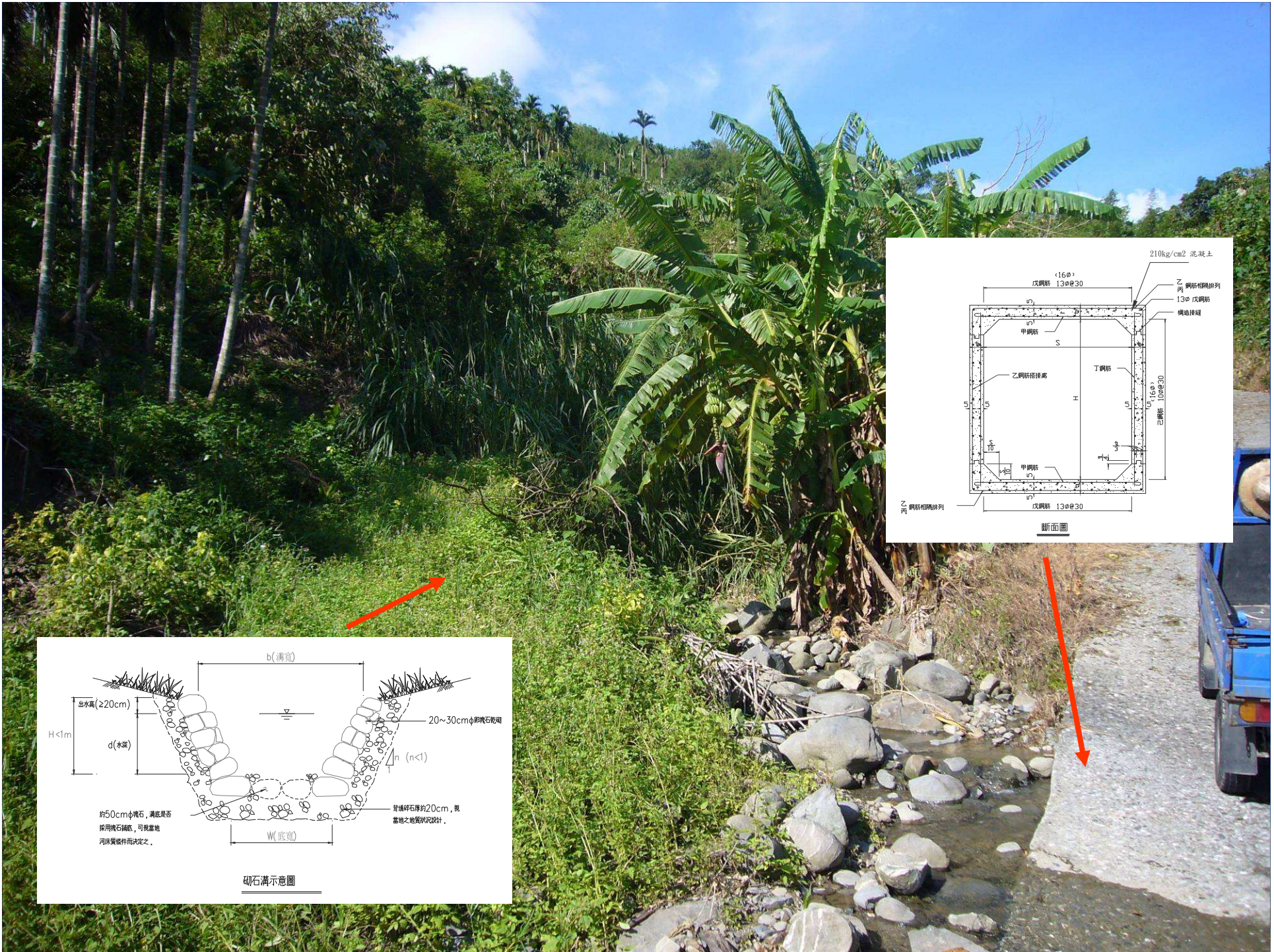

# 鶴岡村20鄰坑溝治理工程



坑溝治理模擬 Simulation of Gully control

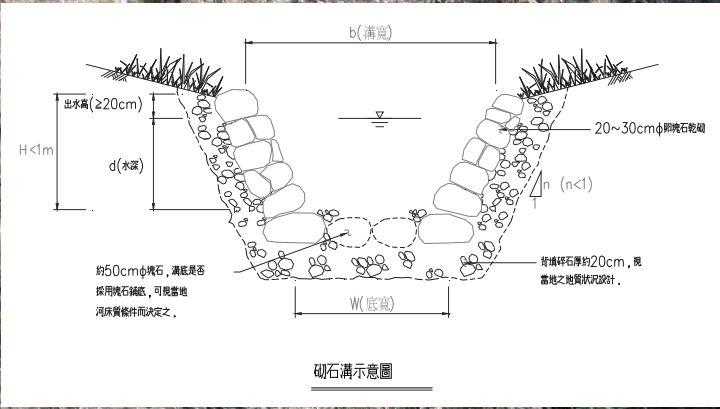
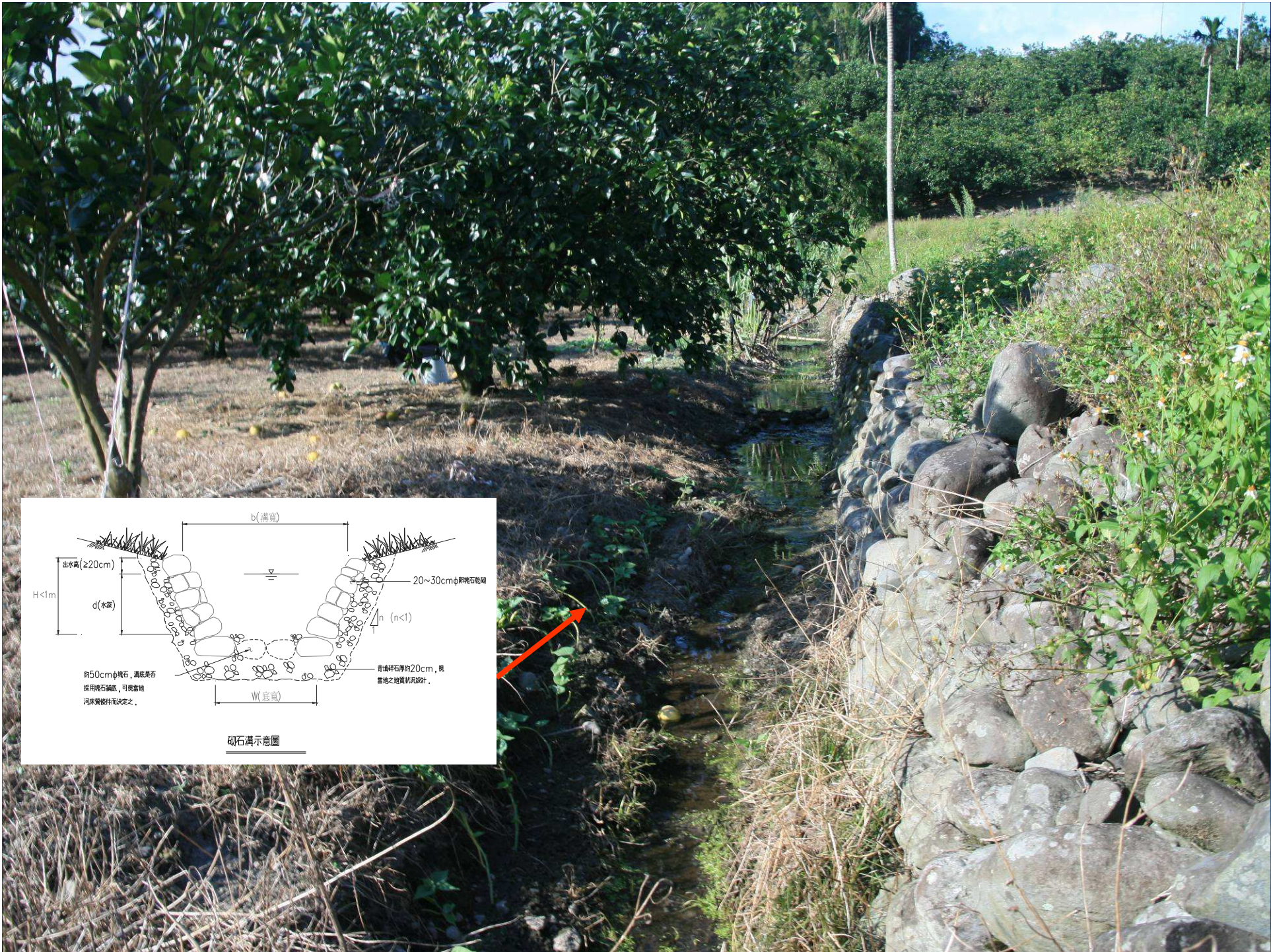

# 舞鶴村加納納7鄰坑溝整治工程



蝕溝治理模擬 Simulation of Erosion control

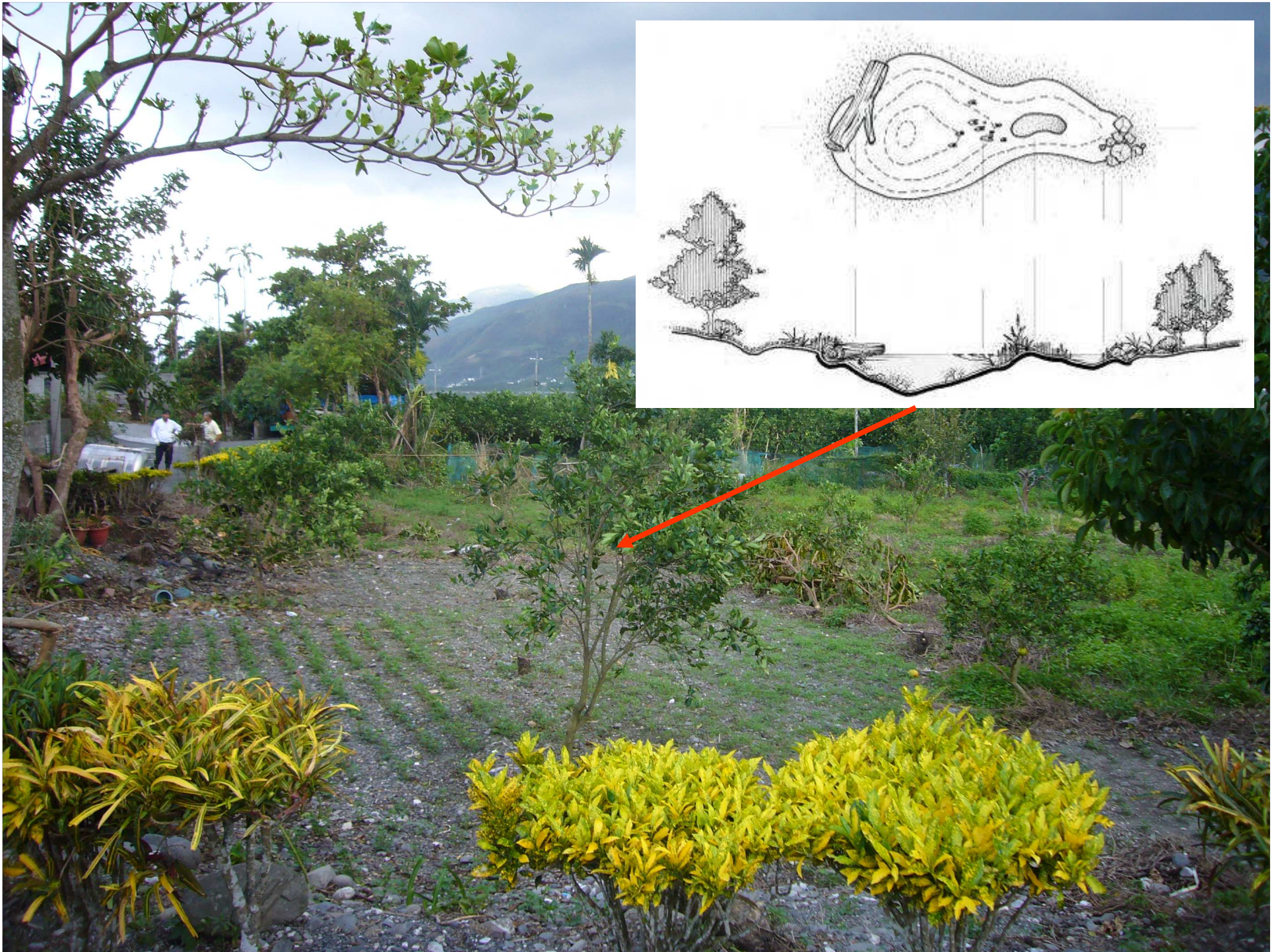

# 鶴岡村10鄰興鶴二街灌溉工程



農塘模擬 Simulation of Farm Ponds



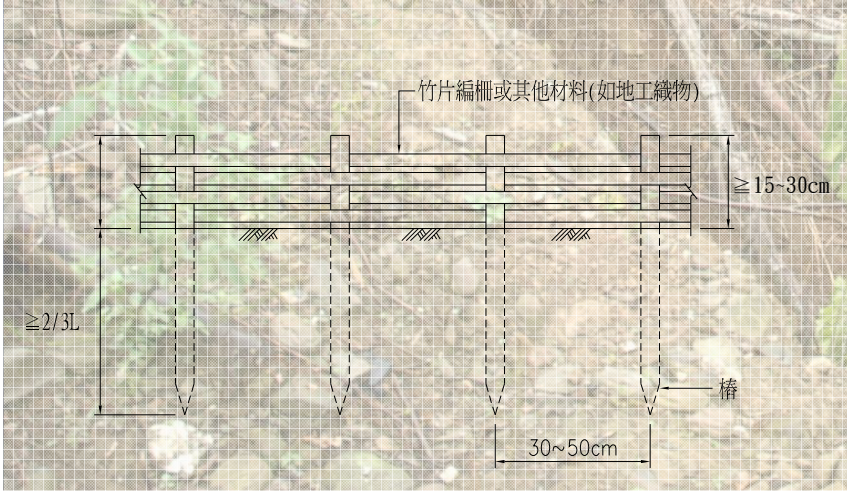
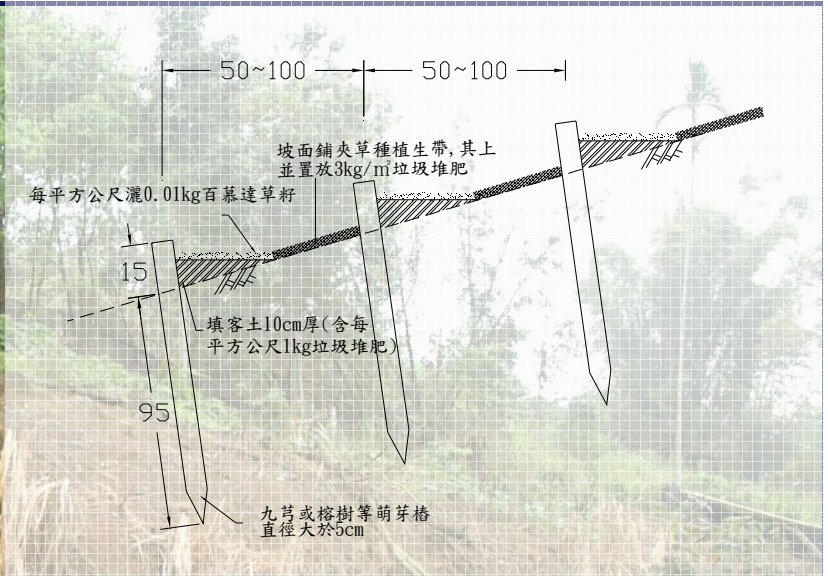

# 舞鶴村加納納7鄰邊坡穩定工程



邊坡治理模擬Simulation of slope remediation work



砌石溝示意圖

# 舞鶴村加納納7鄰坑溝整治工程



坑溝治理模擬 Simulation of Gully control

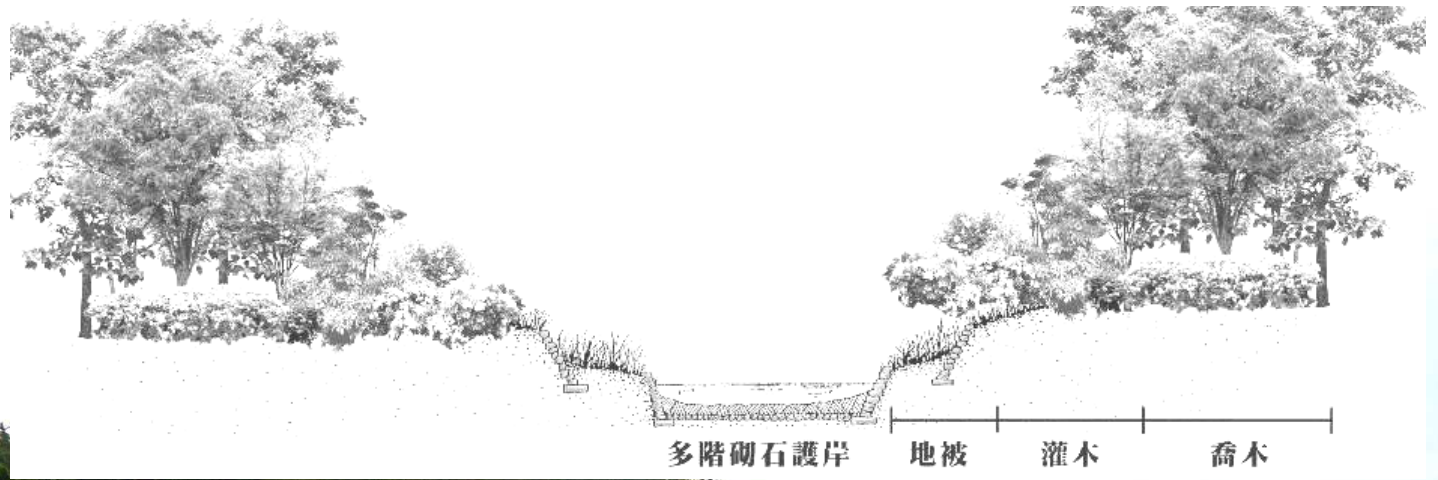

多階砌石護岸 地被 灌木 喬木



# 舞鶴村馬立雲綠覆保育工程



農路改善、緩衝綠帶模擬 Farm road improvement, simulation of buffer zone

# SWOT分析

項次	X	Y	優勢	劣勢	機會	威脅	總分
1	290889	2617557	<ul style="list-style-type: none"> <li>良好水域空間高</li> <li>生態豐富度高</li> </ul>	<ul style="list-style-type: none"> <li>每當雨季時農路通行不易</li> <li>影響農田耕作</li> </ul>	<ul style="list-style-type: none"> <li>著名生態景點服務組織</li> <li>擁有社區解說服務組織</li> </ul>	<ul style="list-style-type: none"> <li>影響道路通行且具有危險性</li> <li>為害住戶安全</li> </ul>	10
			2	3	2	3	
2	290895	2617301	<ul style="list-style-type: none"> <li>原民色彩豐富度高</li> <li>生態豐富度高</li> </ul>	<ul style="list-style-type: none"> <li>農田易淹水</li> <li>河道易淤積影響濕地生態</li> </ul>	<ul style="list-style-type: none"> <li>著名生態景點服務組織</li> <li>擁有社區解說服務組織</li> </ul>	<ul style="list-style-type: none"> <li>破壞整體景觀協調</li> <li>災害易破壞當地生態</li> </ul>	10
			2	3	2	3	
3	292390	2611692	<ul style="list-style-type: none"> <li>絕佳的水域空間</li> <li>坡地景觀優美</li> <li>生態豐富度高</li> <li>產業特色鮮明</li> </ul>	<ul style="list-style-type: none"> <li>缺乏綠覆植生</li> </ul>	<ul style="list-style-type: none"> <li>與大農溪生態池相互結合</li> <li>適合教學遊憩場所</li> <li>具農村風貌特色</li> </ul>	<ul style="list-style-type: none"> <li>地點較不顯著</li> </ul>	15
			4	4	3	4	
4	289037	2603818	<ul style="list-style-type: none"> <li>聯外交通便利良好</li> <li>坡地治理成效高</li> <li>良好水域空間高</li> <li>社區凝聚力高</li> </ul>	<ul style="list-style-type: none"> <li>缺乏綠覆植生</li> </ul>	<ul style="list-style-type: none"> <li>既有治理結合緩衝綠帶</li> <li>發展綜合展示區域特色</li> <li>具農村風貌特色</li> </ul>	<ul style="list-style-type: none"> <li>缺乏維護管理</li> </ul>	14
			4	4	2	4	
5	288989	2605040	<ul style="list-style-type: none"> <li>聯外交通便利</li> <li>產業特色鮮明</li> <li>坡地景觀優美</li> </ul>	<ul style="list-style-type: none"> <li>缺乏蓄水設施</li> <li>農作生產受旱季影響</li> </ul>	<ul style="list-style-type: none"> <li>農塘配合周圍景觀，營造優質農村環境</li> </ul>	<ul style="list-style-type: none"> <li>引水不易</li> </ul>	11
			3	3	1	4	
6	289410	2603550	<ul style="list-style-type: none"> <li>水質清澈優良</li> <li>生態豐富度高</li> </ul>	<ul style="list-style-type: none"> <li>農田遭受沖刷</li> <li>溪水漫流，農路行駛不易</li> </ul>	<ul style="list-style-type: none"> <li>增加農地生產產值</li> </ul>	<ul style="list-style-type: none"> <li>坡度較陡，不易到達</li> </ul>	10
			2	3	1	4	
7	286645	2596006	<ul style="list-style-type: none"> <li>良好水域空間高</li> <li>生態豐富度高</li> </ul>	<ul style="list-style-type: none"> <li>農田遭受沖刷影響</li> <li>右岸農路受影響</li> </ul>	<ul style="list-style-type: none"> <li>為當地青蛙主要棲地</li> <li>鄰近水土保持戶外教室園區</li> </ul>	<ul style="list-style-type: none"> <li>缺乏解說服務組織</li> </ul>	11
			2	3	2	4	
8	286321	2596147	<ul style="list-style-type: none"> <li>產業特色鮮明</li> <li>生態豐富度高</li> </ul>	<ul style="list-style-type: none"> <li>坡面農地流失</li> <li>下邊坡農路安全受影響</li> </ul>	<ul style="list-style-type: none"> <li>位居於加納納阿美族部落</li> </ul>	<ul style="list-style-type: none"> <li>缺乏維護管理</li> </ul>	10
			3	3	1	4	
9	284600	2596472	<ul style="list-style-type: none"> <li>目前坡地治理成效良好</li> <li>擁有水域空間優良</li> <li>治理情況優良</li> <li>農民配合度高</li> </ul>	<ul style="list-style-type: none"> <li>缺乏綠覆植生</li> <li>農路缺乏生態考量</li> </ul>	<ul style="list-style-type: none"> <li>擁有歷史古蹟掃叭隧道</li> <li>擁有馬立雲地特色</li> <li>具農村風貌特色</li> </ul>	<ul style="list-style-type: none"> <li>解說指示系統不明確</li> </ul>	14
			4	3	3	4	

# 大全村願景規劃



0 1,000 2,000  
m

